



**TRI-LAKES (LAKE MECOSTA)  
MECOSTA COUNTY, MICHIGAN  
TREATMENT MAP  
SURVEY DATE: MAY 23, 2024**

**Treatment**

-  Florpyrauxifen-benzyl @ 19.2 fl oz/acre +  
Diquat @ 1 gal/acre (milfoil, curly-leaf) = 1.25 acres
-  Flumioxazin @ 100 ppb + Diquat @ 1 gal/acre  
(milfoil, curly-leaf) = 4.25 acres

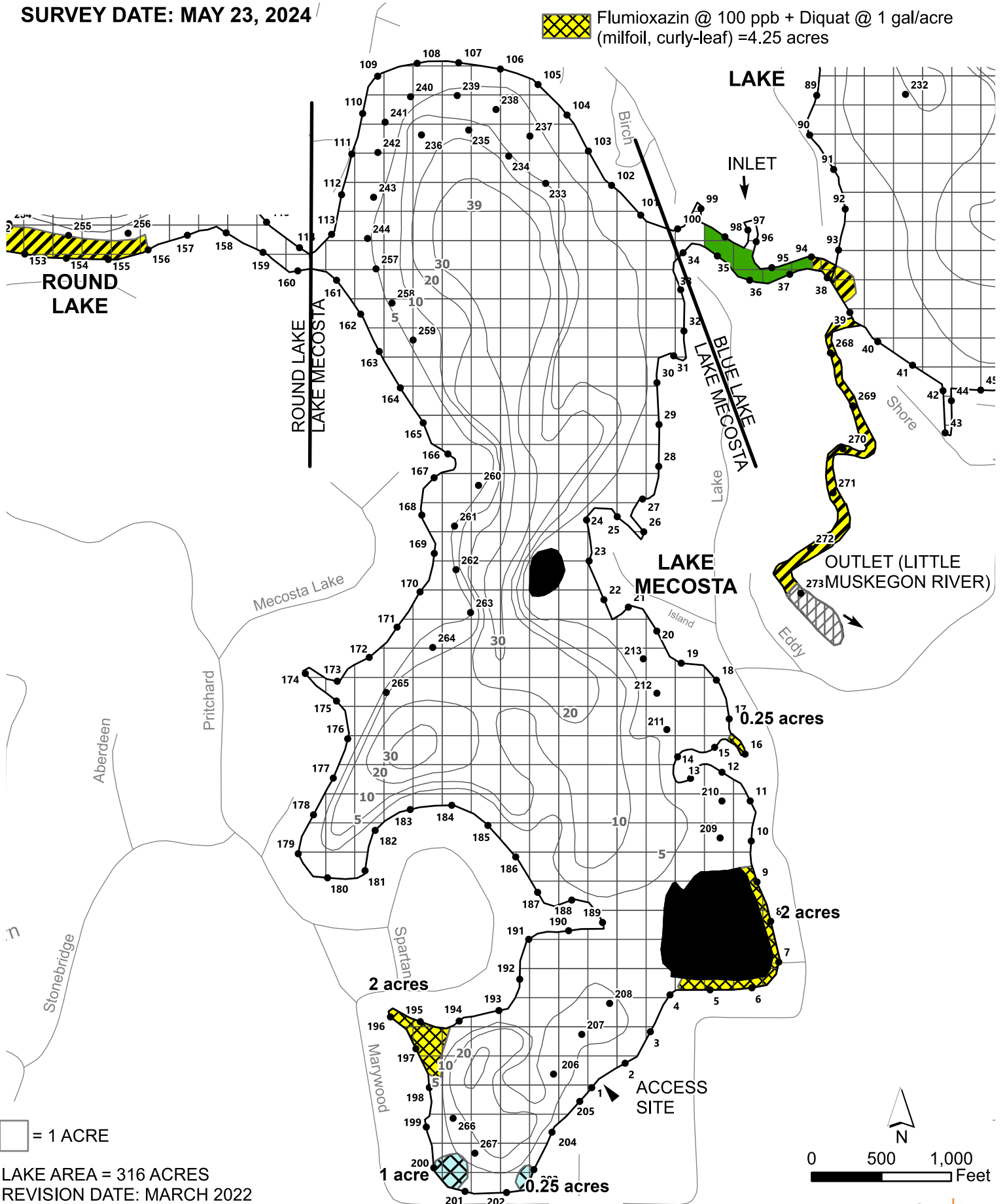

 = 1 ACRE

LAKE AREA = 316 ACRES  
REVISION DATE: MARCH 2022

The applicator shall make adjustments, if needed, to comply with EGLE permit requirements.

progressive | ae

# TRI-LAKES (BLUE LAKE) MECOSTA COUNTY, MICHIGAN TREATMENT MAP

SURVEY DATE: MAY 23, 2024



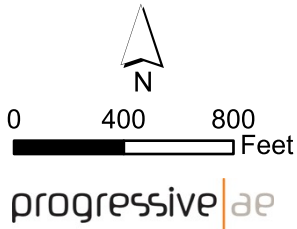

□ = 1 ACRE

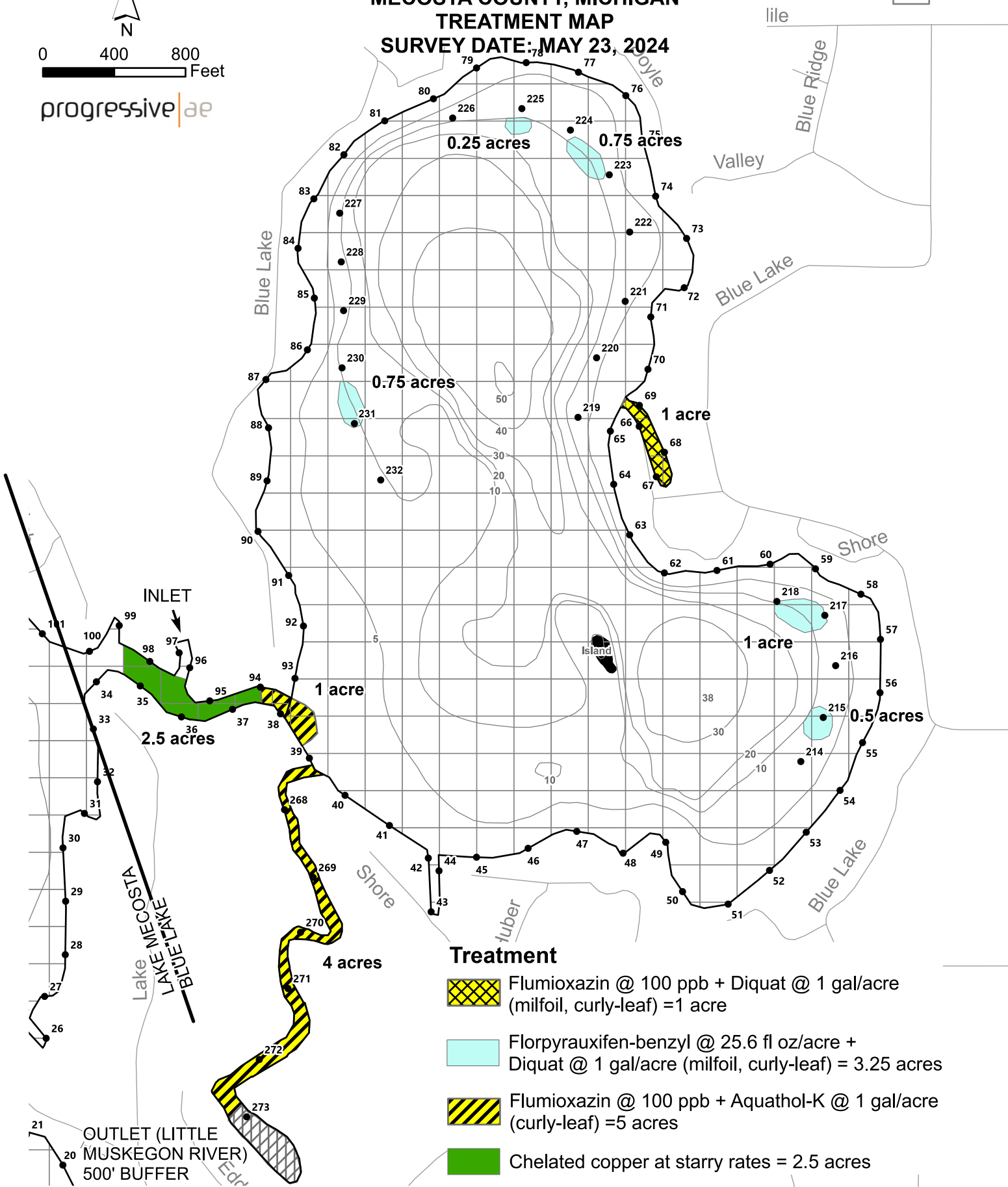

progressive|ae



### Treatment

-  Flumioxazin @ 100 ppb + Diquat @ 1 gal/acre (milfoil, curly-leaf) = 1 acre
-  Florpyrauxifen-benzyl @ 25.6 fl oz/acre + Diquat @ 1 gal/acre (milfoil, curly-leaf) = 3.25 acres
-  Flumioxazin @ 100 ppb + Aquathol-K @ 1 gal/acre (curly-leaf) = 5 acres
-  Chelated copper at starry rates = 2.5 acres

LAKE AREA = 232 ACRES  
REVISION DATE: MARCH 2022

The applicator shall make adjustments, if needed, to comply with EGLE permit requirements.

**TRI-LAKES (ROUND LAKE)  
MECOSTA COUNTY, MICHIGAN  
TREATMENT MAP  
SURVEY DATE: MAY 23, 2024**

□ = 1 ACRE

11 Miles

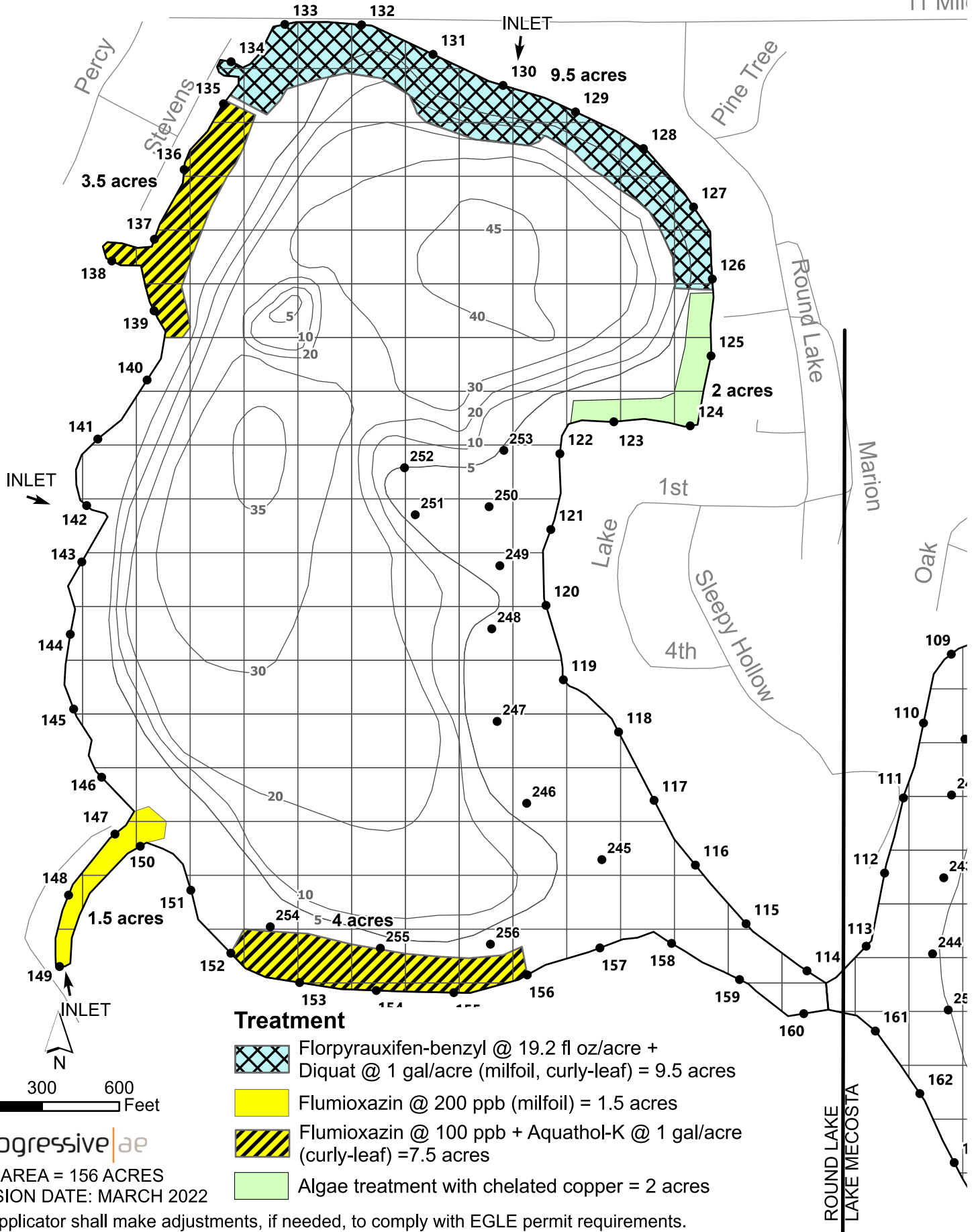

**TRI-LAKES (LAKE MECOSTA)  
MECOSTA COUNTY, MICHIGAN  
TREATMENT MAP  
SURVEY DATE: JUNE 26, 2024**

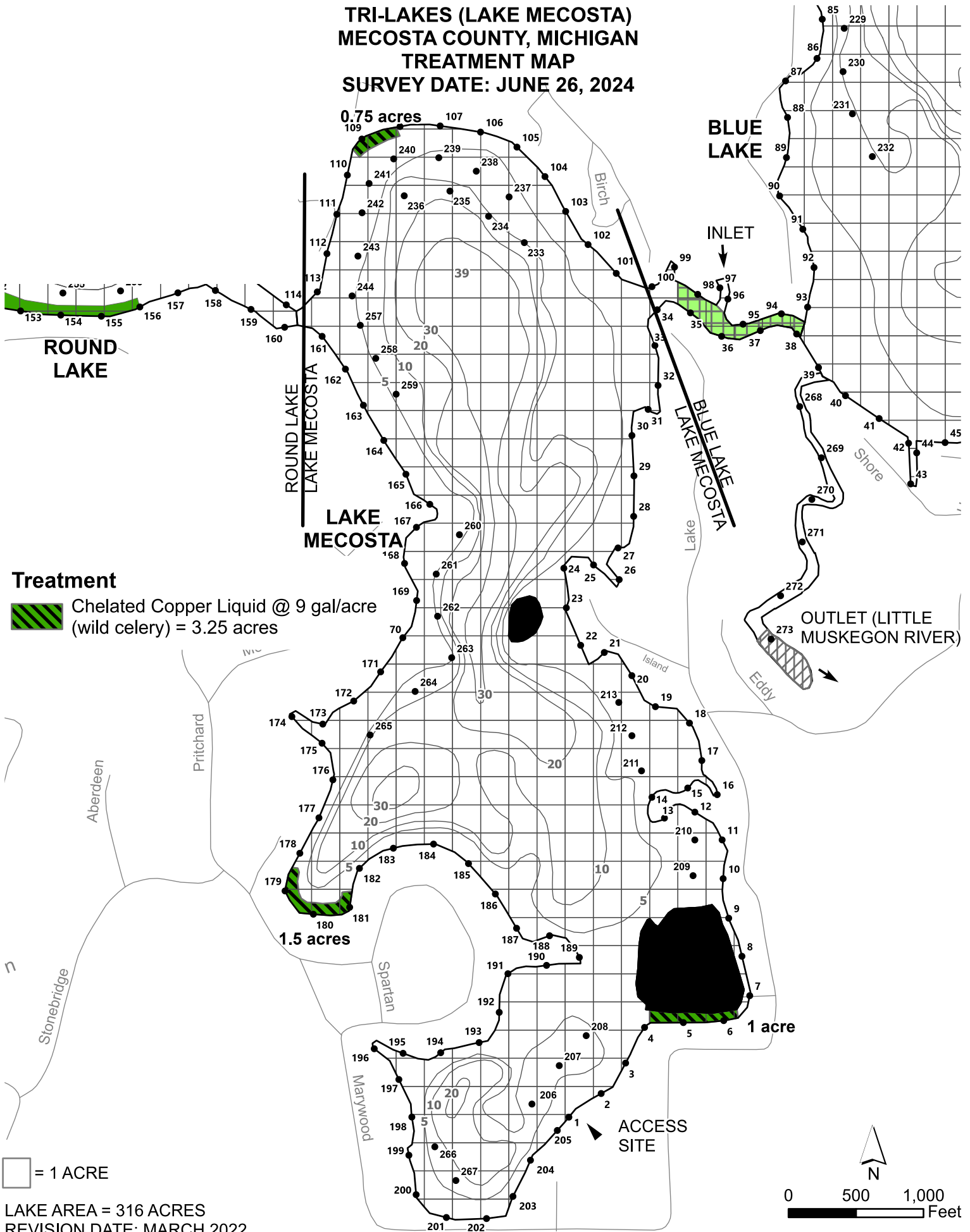

LAKE AREA = 316 ACRES  
 REVISION DATE: MARCH 2022

The applicator shall make adjustments, if needed, to comply with EGLE permit requirements.



**TRI-LAKES (ROUND LAKE)  
MECOSTA COUNTY, MICHIGAN  
TREATMENT MAP  
SURVEY DATE: JUNE 26, 2024**

 = 1 ACRE

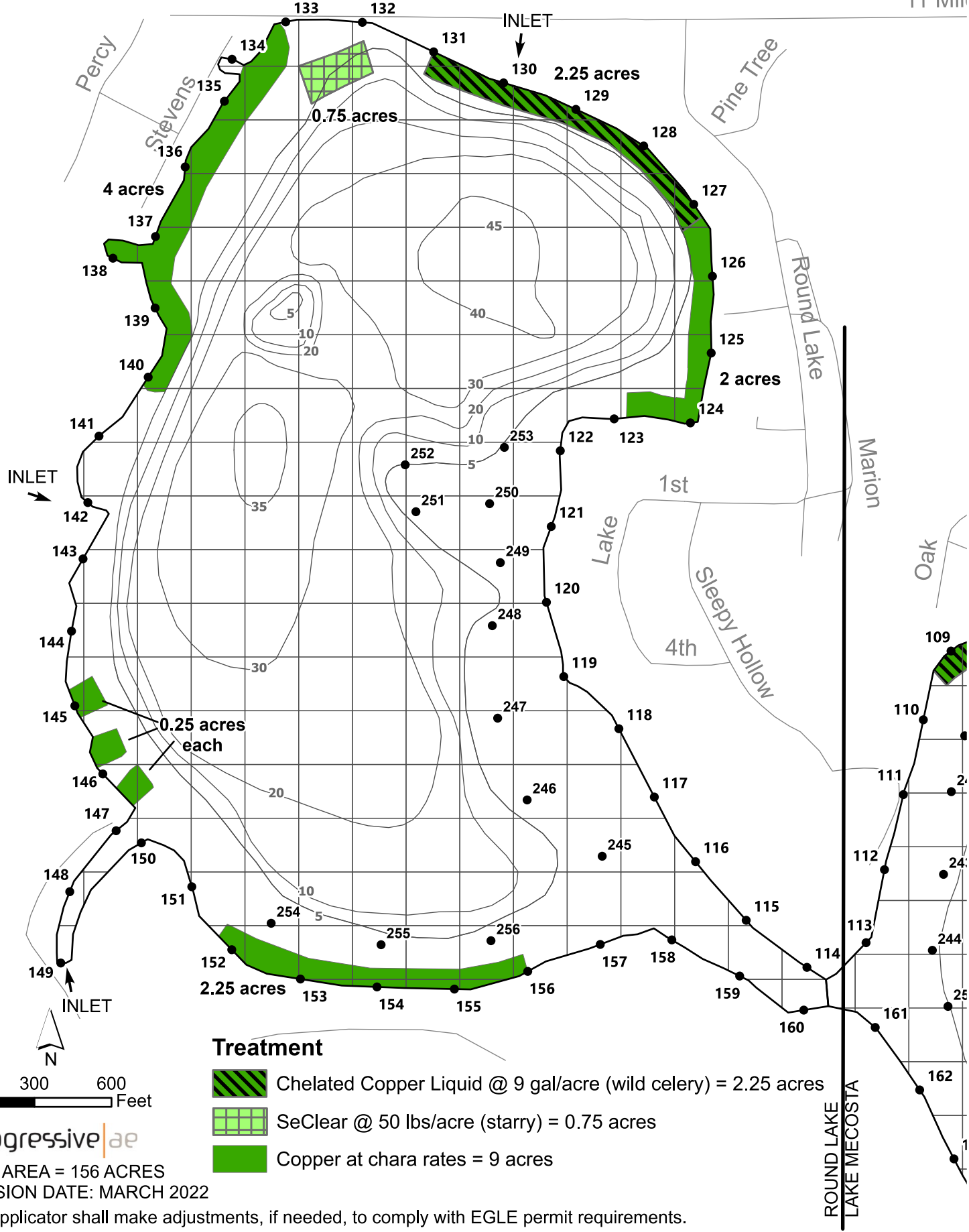
11 Miles



**Treatment**

-  Chelated Copper Liquid @ 9 gal/acre (wild celery) = 2.25 acres
-  SeClear @ 50 lbs/acre (starry) = 0.75 acres
-  Copper at chara rates = 9 acres

0 300 600 Feet

progressive|ae

LAKE AREA = 156 ACRES  
REVISION DATE: MARCH 2022

The applicator shall make adjustments, if needed, to comply with EGLE permit requirements.

**TRI-LAKES (BLUE LAKE)  
MECOSTA COUNTY, MICHIGAN  
TREATMENT MAP  
SURVEY DATE: JUNE 26, 2024**

□ = 1 ACRE

11 Mile



Firch

INLET

2.75 acres

Lake MECOSTA  
LAKE LITTLE  
LAKE DOYLE

**Treatment**

 SeClear @ 50 lbs/acre (starry) = 2.75 acres

OUTLET (LITTLE MUSKEGON RIVER)  
500' BUFFER

21  
20  
213  
19



0 410 820 Feet

LAKE AREA = 232 ACRES  
REVISION DATE: MARCH 2022

The applicator shall make adjustments, if needed, to comply with EGLE permit requirements.

progressive|ae



**TRI-LAKES (BLUE LAKE)  
MECOSTA COUNTY, MICHIGAN  
TREATMENT MAP  
SURVEY DATE: JULY 25, 2024**

□ = 1 ACRE

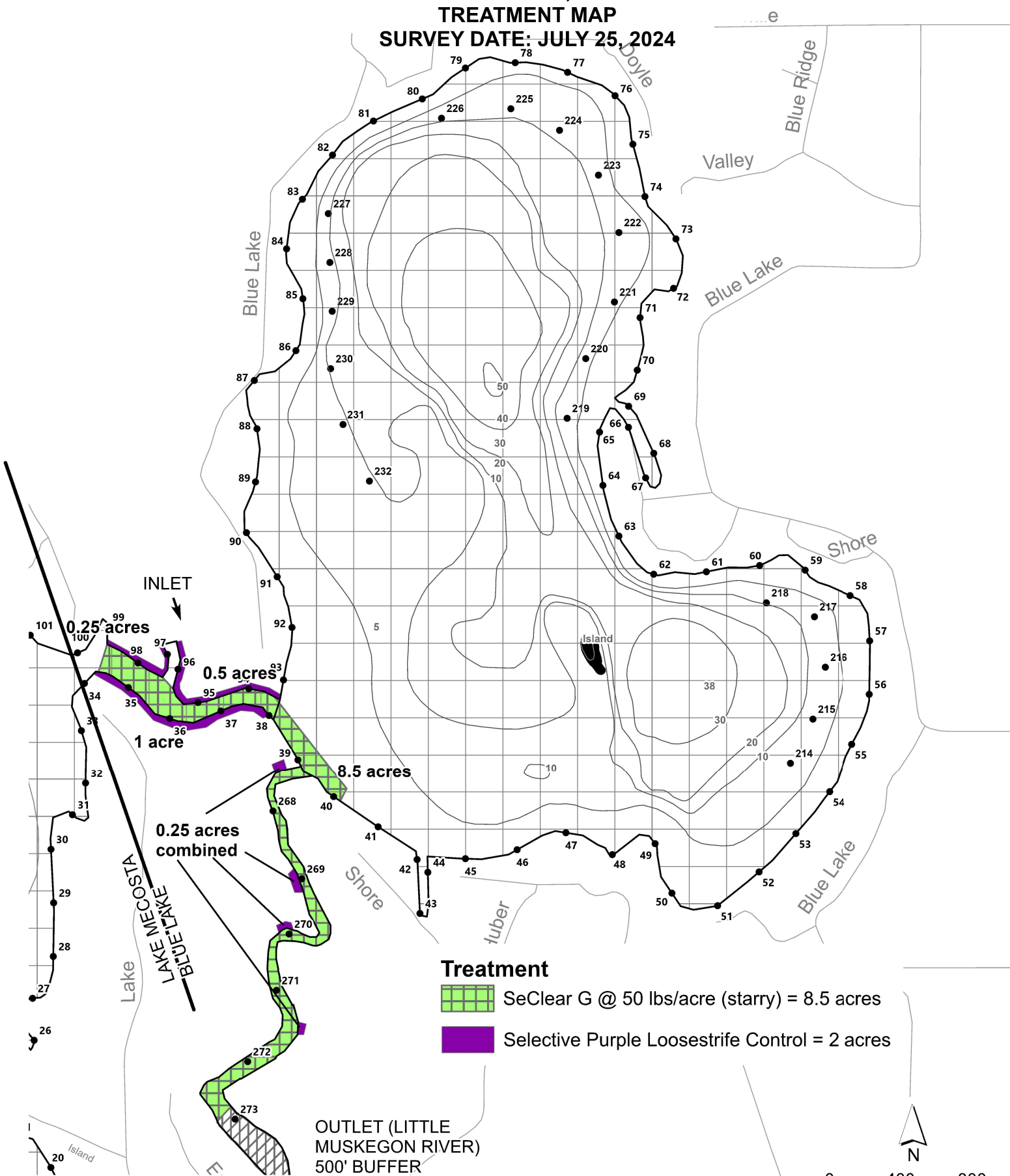

**Treatment**

- SeClear G @ 50 lbs/acre (starry) = 8.5 acres
- Selective Purple Loosestrife Control = 2 acres

OUTLET (LITTLE MUSKEGON RIVER)  
500' BUFFER

LAKE AREA = 232 ACRES  
REVISION DATE: MARCH 2022

The applicator shall make adjustments, if needed, to comply with EGLE permit requirements.

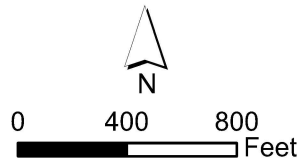

**TRI-LAKES (ROUND LAKE)  
MECOSTA COUNTY, MICHIGAN  
TREATMENT MAP  
SURVEY DATE: JULY 25, 2024**

 = 1 ACRE

11 Miles

